

Tube to Male Pipe

Thermocouple
Male Connector

UTMC

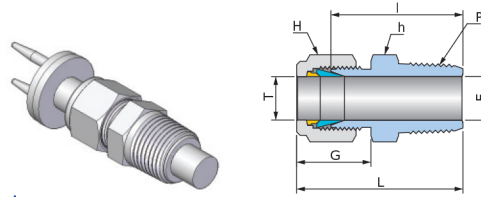

Connects Fractional(Inch) Tube to Female NPT Thread

Part No.	Tube OD T		P NPT	Dimensions (mm)							
	inch	mm		E Min.	h		H		G	I	L
					inch	mm	inch	mm			
UTMC-0204N	1/8	3.17	1/4	3.36	9/16	14.28	7/16	11.11	15.4	29.0	35.8
UTMC-0206N	1/8	3.17	3/8	3.36	11/16	17.46	7/16	11.11	15.4	29.2	36.0
UTMC-0406N	1/4	6.35	3/8	6.53	11/16	17.46	9/16	14.28	17.4	31.0	38.2
UTMC-0408N	1/4	6.35	1/2	6.53	7/8	22.22	9/16	14.28	17.4	37.4	44.6
UTMC-0608N	3/8	9.52	1/2	9.7	7/8	22.22	11/16	17.46	18.9	38.9	46.2
UTMC-0812N	1/2	12.70	3/4	12.88	1-1/16	26.98	7/8	22.22	21.6	40.4	50.4
UTMC-0816N	1/2	12.70	1	12.88	1-3/8	34.92	7/8	22.22	21.6	47.0	57.0

ISO Tapered threads are available for all fractional UTMC. To order, add "R" as a suffix instead of "N".

Connects Metric Tube to Female ISO Tapered Thread

Part No.	Tube OD T		P ISO7/1	Dimensions (mm)					
	mm	mm		E Min.	h mm	H mm	G	I	L
UTMC-M0404R	4	4	1/4	4.18	14.28	12.70	16.1	29.7	36.2
UTMC-M0606R	6	6	3/8	6.18	17.46	14.28	17.6	31.0	38.4
UTMC-M0608R	6	6	1/2	6.18	22.22	14.28	17.6	37.4	44.8
UTMC-M0806R	8	8	3/8	8.18	17.46	15.87	18.7	31.8	39.3
UTMC-M0808R	8	8	1/2	8.18	22.22	15.87	18.7	38.1	45.6
UTMC-M1008R	10	10	1/2	10.18	22.22	19.05	19.5	38.9	46.6
UTMC-M1212R	12	12	3/4	12.18	26.98	22.22	21.7	38.9	49.0

NPT threads are available for all metric fractional UTMC. To order, add "N" as a suffix instead of "R".

Bored - Through Fittings

Bored-through male connectors handle thermocouples or tip tubes easily.

Most Kor-Lok male connectors can be bored-through fittings.

The following fittings are impractical to make bored-through fittings.

- Male connector with small pipe thread end as 1/8"
- Male connectors which tube fitting end is larger than pipe thread end such as 06UMC-02R- or M12UME-04N-.

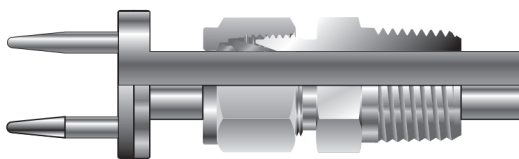

Dimensions are for reference only and are subject to change without prior notice.
E is minimum opening. F, G and L are typical finger tight.

Heat Exchanger Tee

Kor-Lok union tees and reducers can make heat exchange tees.

